



THE ROSS WALKING TOUR

Welcome to Michigan Ross

The school is named for Stephen M. Ross, who graduated from the University of Michigan Business School in 1962 with a Bachelor of Business Administration degree. He is founder and chairman of Related Companies, a major real estate development firm based in New York.

The main Ross building opened in 2009. Jeff T. Blau Hall and the renovated Kresge Hall opened in 2016. All three buildings are LEED certified, recognized for using sustainable materials and numerous environmentally friendly features, including “green roofs” made of living plants.





THE MICHIGAN ROSS COMPLEX

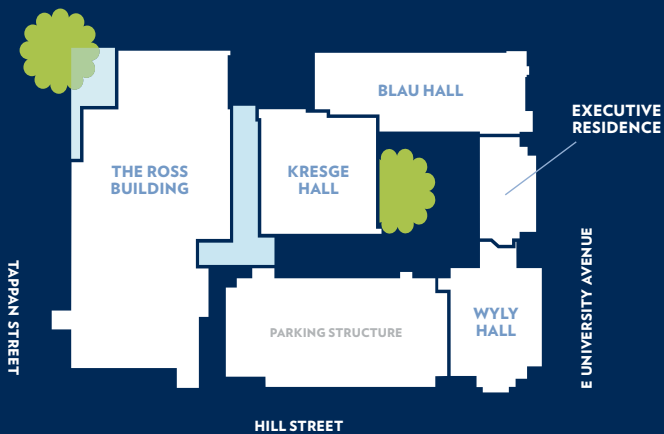

THE ROSS BUILDING

Enter Michigan Ross through the front entrance, 701 Tappan St., Ann Arbor.

LEVEL 1



1A

ROBERTSON AUDITORIUM

From the Tappan Street entrance, walk straight down the main hall, past the stairs on the left.

Turn left at the “Butterfield Horses” sculptures in the Stewart Lobby, part of an extensive art collection found throughout the Ross campus.

If no event is taking place, feel free to look inside.

- › Hosts business competitions, large conferences with national speakers, and major university speeches.
- › Home to student-organized events like the Michigan Sport Business Conference and the Women in Business speaker series.
- › Broadcast-quality output is available to reach audiences outside the auditorium and online.

1B

DAVIDSON WINTER GARDEN

Return to the large, open atrium off the Tappan Street entrance; this is the Davidson Winter Garden.

As you walk through, feel free to grab a bite to eat at Seigle Café or a drink at Starbucks.

- › Students from all Michigan Ross academic programs use this space.
- › It serves as a place to study, a space for group projects, or a spot to meet a friend.
- › Near Robertson Auditorium, you may see recruiters speaking with students. Leading companies across a wide range of industries come to Michigan Ross to find talent for their organizations.





1C CLASSROOMS

Located on the main level alongside the Davidson Winter Garden, on the lower level, and on the second level.

If you see an open classroom, feel free to look inside.

- › Integrated technology in all classrooms includes projection screens, interactive resources, and outlets for student laptops on classroom tables.
- › Our curriculum emphasizes peer-to-peer and student-to-professor interactions that cultivate learning by doing.
- › U-shaped classrooms allow for great conversations and inclusive interactions.



1D GROUP STUDY ROOMS

*Located on the main level
and throughout the building.*

- › These rooms are used for group projects, collaborative work, and meetings of student organizations.
- › Rooms are equipped with large screen monitors and videoconferencing capabilities and whiteboards for brainstorming.
- › An online room reservation system is displayed on the small screen next to each door.



LOWER LEVEL

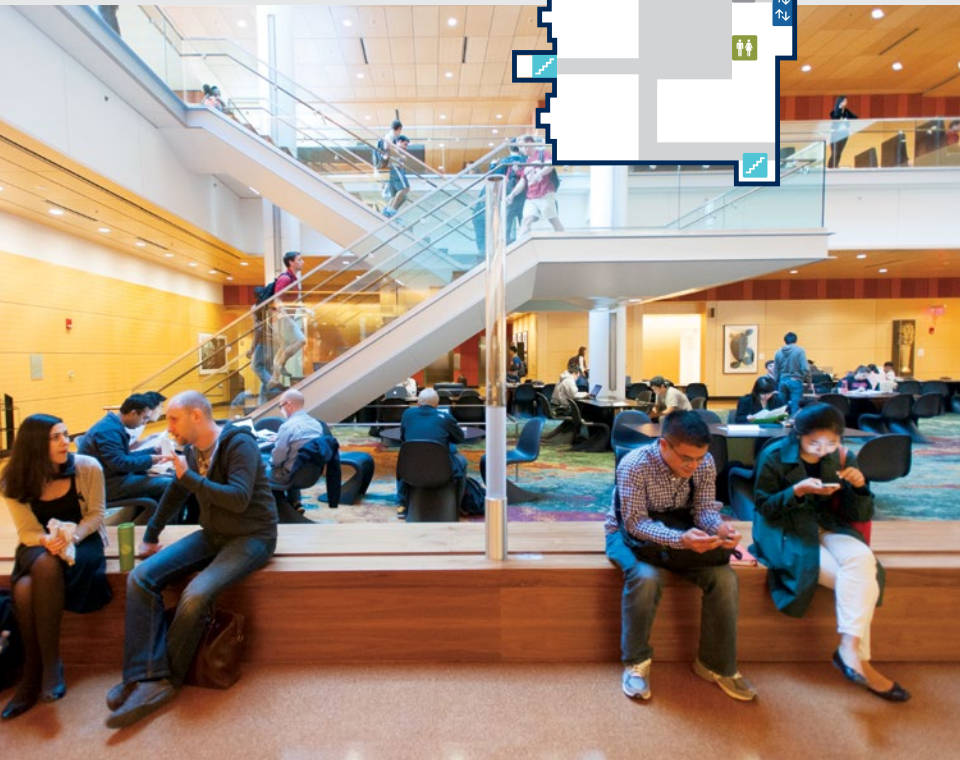



LA **TOZZI ELECTRONIC BUSINESS AND FINANCE CENTER**

Take the elevator or stairs next to Starbucks down to the lower level. If the lab is open and a class is not in session, feel free to ask the Tozzi Manager any questions you may have.

- › This center includes a mock trading floor, e-lab, and electronic modular classroom.
- › Students can earn certifications in Fact Set and Bloomberg. They have access to the Dow Jones Newswire, Barra Portfolio Manager, and other software services.
- › Skills gained here prove greatly beneficial when interviewing for opportunities in finance.

LB **OCH FITNESS CENTER**

Stay on the lower level. From the bottom of the staircase, turn right and head to the end of the long hall. Ask at the gym desk if you may look inside.

- › Facilities are available to Ross students, faculty, and staff.
- › Personal trainers are available, along with classes in yoga, Pilates, and circuit training.
- › Students can gain access to the gym by purchasing a membership.



LEVEL 3

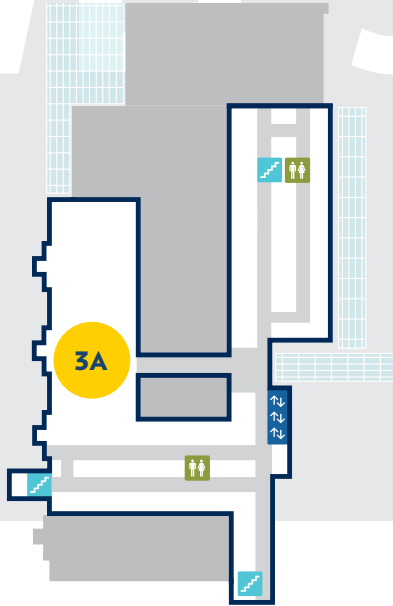

3A ZELL LURIE INSTITUTE

Take the elevator to the third level, which also houses administrative and faculty offices. Exit the elevator to the right and head through the glass doors on the left. ZLI is located across the walkway.

- › ZLI offers Michigan Ross students the community, network, curriculum, and support necessary to succeed as corporate or autonomous entrepreneurs.
- › The Michigan Business Challenge and the Michigan Investment Challenge engage student entrepreneurs and student investors with national business leaders to kick-start ideas.
- › The Applebaum Dare to Dream grant program provides seed money (up to \$5,000) to students engaging in entrepreneurship while earning their degree.

LEVEL 6



6A TAUBER COLLOQUIUM

Exit the elevator and walk to the right down the hall. As you approach the Tauber Colloquium, enjoy spectacular views of the campus and beyond.

Note Michigan Stadium off to the left and the Law School to the right.

Take the elevators back to the main level.

- › Hosts special events; conferences; and speakers, including C-level executives.



KRESGE AND BLAU HALLS

To visit the other buildings on the Ross complex, walk back through the Davidson Winter Garden, turning right as you approach Robertson Auditorium. Exit the building through the doors near the horse sculptures and cross the walkway to enter Kresge Hall on level 1.

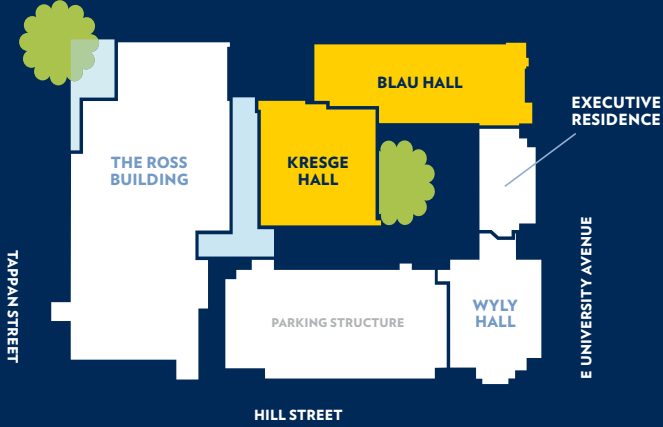

Kresge L1-3 PROGRAM OFFICES AND THE CENTER FOR CENTERS

Kresge Hall's lower and first levels house open study areas and, on your right as you walk down the main hallway, the Caplan Graduate Admissions Suite.

- › **L1:** Caplan Graduate Admissions Suite
- › **L2:** Graduate Program Offices (MBA, MAcc, MBAn, MM, and MSCM)
- › **L3:** Undergraduate Admissions and Office of Undergraduate Programs, Thomas C. Jones Initiative of Innovation in Undergraduate Business Education, Registrar's Office, and Financial Aid
- › **L3:** The Center for Centers is home to our renowned centers, institutes, and initiatives, including Sanger Leadership Center, Tauber Institute for Global Operations, Business+ Impact, Erb Institute, Global Initiatives, and the Center for Positive Organizations.

Kresge L4 KRESGE LIBRARY

OFFICE OF DEVELOPMENT AND ALUMNI RELATIONS

- › Kresge Library services the research, instruction, and curriculum needs of students and faculty.
- › Learn about the benefits and opportunities available through our *AlumniAdvantage* program.

Blau L1-3 CLASSROOMS

As you walk down the main atrium corridor, you are now in Jeff T. Blau Hall.

- › Blau Hall houses state-of-the-art classrooms and study spaces, including a flexible classroom space designed to facilitate team-based active learning on Level 2.

Blau L2 CAREER DEVELOPMENT OFFICE

- › The Career Development Office develops relationships with companies and provides individualized career support to students.

Blau L5 BLAU COLLOQUIUM

- › This space hosts special events, conferences, speakers, trade shows, and more.

EXECUTIVE RESIDENCE

On level 2 of Blau Hall, turn right at the end of the corridor to enter the +Impact Studio.



L2

+IMPACT STUDIO & LBLE BOARDROOMS

Past the LBLE boardrooms is the Executive Learning & Conference Center in Wyly Hall.

- › The +Impact Studio is an interactive campus hub for design and impact that hosts workshops, design jams, and guest speakers throughout the year.
- › Living Business Leadership Experience (LBLE) boardrooms provide space for course group meetings and study sessions.

L1

SEVEN10 EAST

Return to the +Impact Studio entrance and travel to level 1 to reach Seven10 East.

- › This cafe offers a study space and Zingerman's coffee, pastries, and sandwiches.

EXECUTIVE RESIDENCE LOBBY

Walking through Seven10 East will bring you to the Executive Residence hotel lobby.

- › The Executive Residence is a full-service hotel used by participants in Executive Education and Executive MBA programs, as well as other guests.
- › Find our Executive Dining Room on the lower level.

Exit the building on the opposite side of the hotel lobby. Directly in front of you is Wyly Hall, used primarily for Executive Education programs. Turn right and walk past the Alessi Courtyard, back into the main Ross building, to conclude your tour.

ADMISSIONS INFORMATION

Please visit michiganross.umich.edu for more information on the admissions process and prerequisites for all our degree programs.

michiganross.umich.edu

M | MICHIGAN ROSS

Stephen M. Ross School of Business
University of Michigan
701 Tappan St.
Ann Arbor, MI 48109-1234

The Regents of the University of Michigan

Jordan B. Acker, Michael J. Behm, Mark J. Bernstein, Paul W. Brown, Sarah Hubbard, Denise Ilitch, Ron Weiser, Katherine E. White, Santa Ono (*ex officio*)

University of Michigan Nondiscrimination Policy Notice

The University of Michigan, as an equal opportunity/affirmative action employer, complies with all applicable federal and state laws regarding nondiscrimination and affirmative action. The University of Michigan is committed to a policy of equal opportunity for all persons and does not discriminate on the basis of race, color, national origin, age, marital status, sex, sexual orientation, gender identity, gender expression, disability, religion, height, weight, or veteran status in employment, educational programs and activities, and admissions. Inquiries or complaints may be addressed to the Senior Director for Institutional Equity, and Title IX/ Section 504/ADA Coordinator, Office for Institutional Equity, 2072 Administrative Services Building, Ann Arbor, Michigan 48109-1432, 734-763-0235, TTY 734-647-1388, institutional.equity@umich.edu. For other University of Michigan information call 734-764-1817.

© 2022 The Stephen M. Ross School of Business at the University of Michigan

